

# Steckverbindersystem für Bandkabeltechnik / Flat Cable Connector System

## Bauform C – Serie 120 / Type C Series 120

64- und 96-polige Messerleisten – dreireihig – mit Kodierung  
 64 and 96 contact male connectors – three row – with polarization

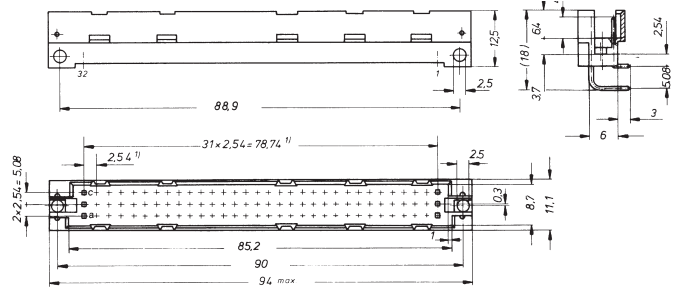

### Lochbild / Printed circuit layout

Tauchlöten abgewinkelt / Dip solder angled

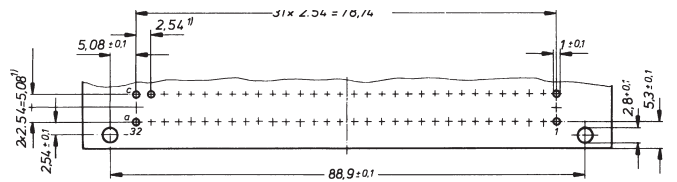

Tauchlöten gerade / Dip solder straight

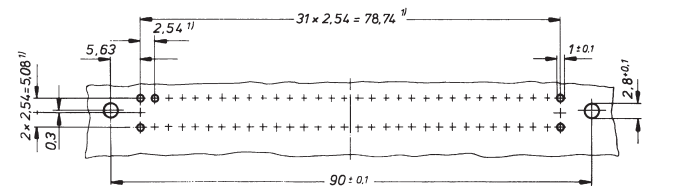

Bestell-Nummer / Part number

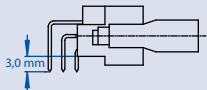
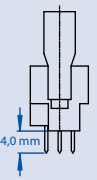
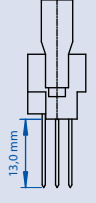
Polzahl No. of contacts	Anforderungsstufe Performance level	Ausführungsart / Anschlussarten Style / Termination methods		
		 Tauchlöten abgewinkelt Dip solder angled	 Tauchlöten gerade Dip solder straight	 Wickeln Wire wrap
64	2	<b>120-964-033A</b>	<b>120-964-133A</b>	<b>120-964-131A</b>
96	2	<b>120-096-033A</b>	<b>120-096-133A</b>	<b>120-096-131A</b>

ohne Auswerfer 120-964-... (ohne Index-A) / without ejector 120-964-... (without index-A)

## Steckverbindersystem für Bandkabeltechnik / Flat Cable Connector System

### Bauform C – Serie 120 / Type C – Series 120

64- und 96-polige IDC Federleisten – dreireihig – mit Kodierung  
 64 and 96 contact IDC female connectors – three row – with polarization

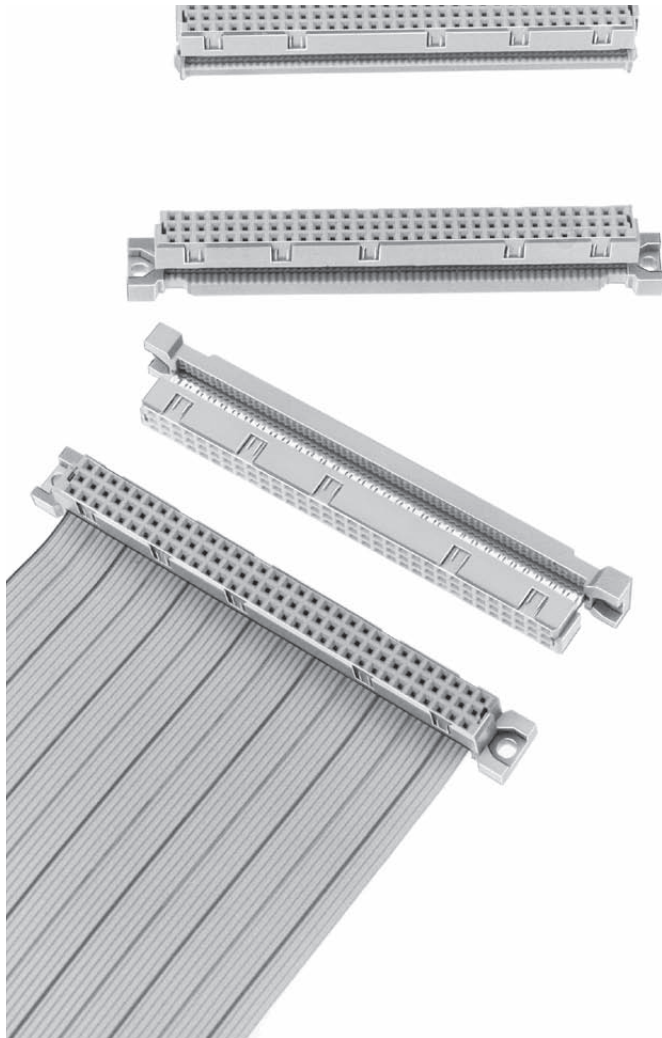

#### 64-polig / 64 contacts

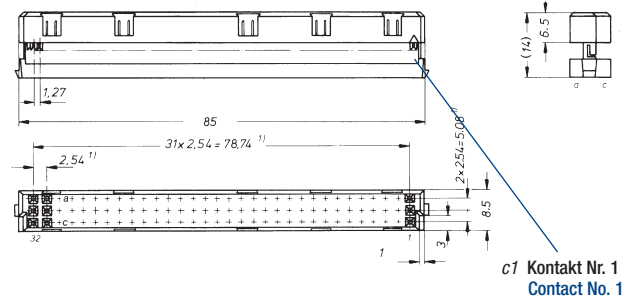

#### Abmessungen nach DIN 41612 Dimensions according to DIN 41612

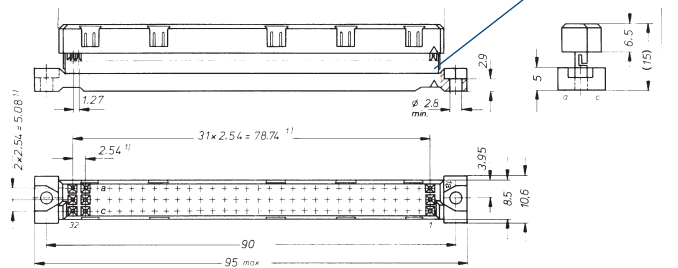

#### 96-polig / 96 contacts

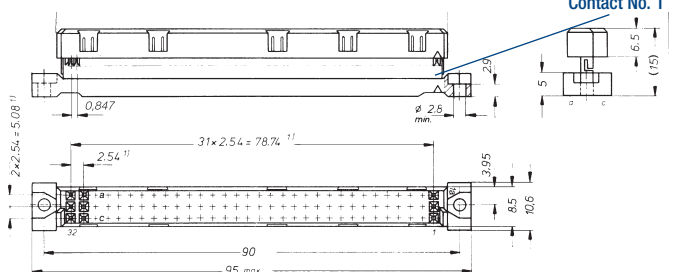

#### Bestell-Nummer / Part number

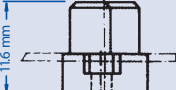
Typ Type	Polzahl No. of contacts	Bestückung Contact arrangement	Anforderungsstufe Performance level	Anschlussarten Termination methods	
					
C	64	Reihe a + c Row a + c	2	<b>120-964-435</b>	<b>120-964-435F</b>
C	96	Voll bestückt Fully equipped	2	<b>120-096-435</b>	<b>120-096-435F *</b>

\* Zugentlastungsbügel Metall 120-000-046 / \* Strain relief Bracket 120-000-046